



Interceptus

The first GS1 UK certified healthcare application.

TAKE CONTROL OF WRISTBAND PRINTING

Interceptus gives you the control to print barcoded wristbands to NPSA, ISB and GS1 standards.

Client or server installations work behind the scenes with no extra user input to intercept and convert your current PAS output.

Flexible template design, support for both 1D and 2D GS1 barcodes, merge data from multiple data sources, full control of the print destination and format make Interceptus a powerful tool to enhance patient safety and workflow efficiency within the hospital.

Key features:

- Transparent to the end user.
- Flexible template design. Templates can be updated in-house.
- Complicated media with labels and multiple wristbands made easy using "Template in Template".
- Print clear accurate data small enough to fit on sample labels and baby wristbands.
- GS1 standards are fully met. Interceptus is the first healthcare product to be certified by GS1.
- Print 1D and 2D barcodes containing fixed and variable data. (Print 1D now and migrate to 2D later).
- Built in expressions for manipulating data.
- Client or Server installations.
- PAS print jobs can trigger data look ups via stored procedures in SQL Server or equivalent data sources.
- Data formatted to meet NPSA and ISB standards. Eg. SURNAME Forename, 01-Jan-2009, 999 999 9999 etc.
- Laser printer emulation with support for LPR/LPD and EPL/PCL/ZPL printer languages.
- Flexible data parsing rules can be updated in-house.

"We needed a solution that worked with our legacy PAS to help create printed wristbands. Herbert Healthcare have provided an excellent solution and made it an easy project due to their professionalism and excellent customer care."

Mick Fox
ICT Infrastructure Services Manager
North Tees and Hartlepool NHS Foundation Trust



HERBERT HEALTHCARE

Tel: 01440 711400
healthcare@herbertgroup.com
18 Rookwood Way, Haverhill, Suffolk, CB9 8PD

GS1 UK
Guidelines for Automatic Identification and Data Capture for Patient

Advance Notification: AN1507
Date of Issue: October 2009

Information Standards Board
for Health and Social Care

Issuing Organisation: Department of Health
Prepared: 01 July 2010
Subject: Notification: AIDC - Bar Code for Patient Identifiers on the Identity Band

This gives advance notice to Information Standards Board members on 29 July 2010.

Summary
This project standardises the identity band used in all health systems. The standard will allow for system suppliers that share the same standard to be used. Subject to the approval of delivering NHS contracts, identity band will be used. Related ISB/ISB, the bar code is standardised by the ISB on identity bands.

Information Standards Board
The Information Standards Board (ISB) is a statutory body established by the Health Act 2009.

For action by Chief Executives
Standardising wristbands improves patient safety

Wristbands are used to identify hospital inpatients. Over the 12 month period February 2009 to January 2010, the NHS received 24,382 reports of patients being misidentified to their care.

It is estimated that more than 2500 of these related to wristbands and their use. Standardising the design of patient wristbands, the information on them, and the processes used to produce and check them, will improve patient safety.

This Safety Practice Notice sets out the action to be taken by the NHS to ensure wristbands are standardised.

Action for the NHS

From 18 July 2010, all NHS organisations in England and Wales that use patient wristbands should ensure that their wristbands meet the NPSA/ISB requirements. See www.npsa.nhs.uk.

1. Only include the following core patient information on wristbands:
 - Full name
 - First name
 - Last name
 - Date of birth
2. Only include the following core patient information on wristbands:
 - First name
 - Last name
 - Date of birth
 - First name of the NHS. Number is not necessarily available, a temporary number should be used until it is available.
 - First line of address (this only applies to those who do not live in a Welsh Health Council).
3. Develop clear and consistent approaches, set out in your products, specifying which staff can produce, apply and check patient wristbands, how they should do it and what information needs to be included.
4. Only use a unique identifier on the back of the wristband to have a system for identifying a patient for the purpose of an identity band. A patient should not wear to receive blood or blood products, the wristband should be used with patient identifiers in black text on a white ground on the wristband.

Information about implementing the recommendations above is available in the accompanying questions and answers. You can find it at www.npsa.nhs.uk/identity

Interceptus prints wristbands to meet:

- National Patient Safety Agency SPN24
- NHS Information Standards Board Advance Notice AN0907
- GS1 Standards
- Local specific requirements

Automatically handles:

- Case formatting of Surname and Forename
- Formatting NHS Numbers to 3-3-4 format
- Formatting dates to DD-MMM-YYYY format
- Generating GS1 compliant barcodes
- GS1 128 1D linear code
- GS1 Datamatrix 2D code

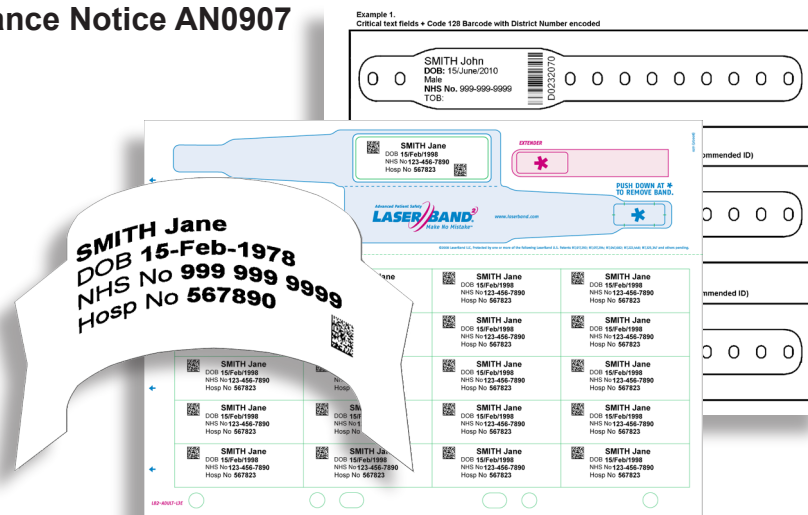

Flexible template design:

- Can be designed and edited by end users and managed centrally.
- Accurate positioning of text and barcode data.
- 2D and 1D barcodes can be used in the same template and can be switched easily.
- Multiple orientation, font sizes and formatting available.

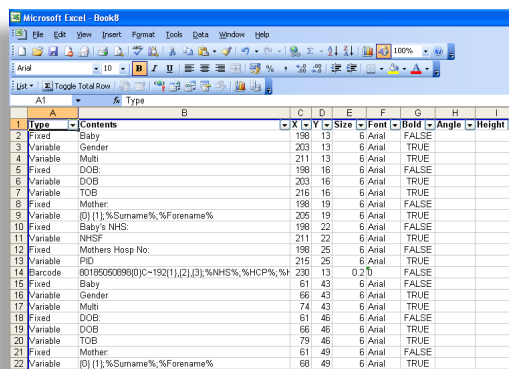



Type	Contents	X	Y	Size	Font	Bold	Angle	Height
Fixed	Baby	198	13	6	Arial	FALSE		
Variable	Gender	203	13	6	Arial	TRUE		
Variable	Multi	211	13	6	Arial	TRUE		
Fixed	DOB	198	16	6	Arial	FALSE		
Variable	DOB	203	16	6	Arial	TRUE		
Variable	TOB	216	16	6	Arial	TRUE		
Fixed	Mother	198	19	6	Arial	FALSE		
Variable	{0} {1} %Surname%, %Forename%	205	19	6	Arial	TRUE		
Fixed	Baby's NHS	198	22	6	Arial	FALSE		
Variable	NHSF	211	22	6	Arial	TRUE		
Fixed	Mothers Hosp No.	198	25	6	Arial	FALSE		
Variable	PID	215	25	6	Arial	TRUE		
Barcode	80185050880{0}C-192{1,1,2}, {3}, %NHS%, %HCP%, %	230	13	0, 2		FALSE		
Fixed	Baby	61	43	6	Arial	FALSE		
Variable	Gender	66	43	6	Arial	TRUE		
Variable	Multi	74	43	6	Arial	TRUE		
Fixed	DOB	61	46	6	Arial	FALSE		
Variable	DOB	66	46	6	Arial	TRUE		
Variable	TOB	79	46	6	Arial	TRUE		
Fixed	Mother	61	49	6	Arial	FALSE		
Variable	{0} {1} %Surname%, %Forename%	68	49	6	Arial	TRUE		

Adaptable data input:

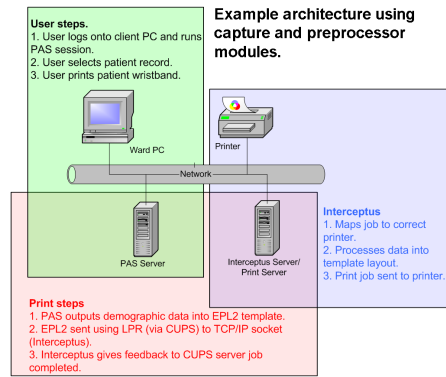
- Interceptus can intercept your existing print jobs including:
- EPL, ZPL, PCL and plain text (subject to parsing)
 - Print jobs can be redirected and intercepted locally (on client PCs) or centrally via a network print server.
 - Dozens of printers can be handled including multiple media types, templates and even a mixed estate of different brands of printer.
 - Customisation is available to offer complete flexibility subject to individual requirements and constraints.



<p>Technical Requirements:</p> <p>Operating system: Microsoft Windows XP Microsoft Windows 7 Microsoft Windows 2003 Server Microsoft Windows 2008 Server</p> <p>Microsoft .NET Framework 3.5 SP1 or higher Windows drivers for all print hardware.</p>	<p>Barcode Symbologies:</p> <p>One Dimensional: Code 128 GS1 128</p> <p>Two Dimensional: ECC 200 Datamatrix GS1 Datamatrix</p>	   <p>ISO9001 FM01006</p>
--	---	--